

# BRISTOL

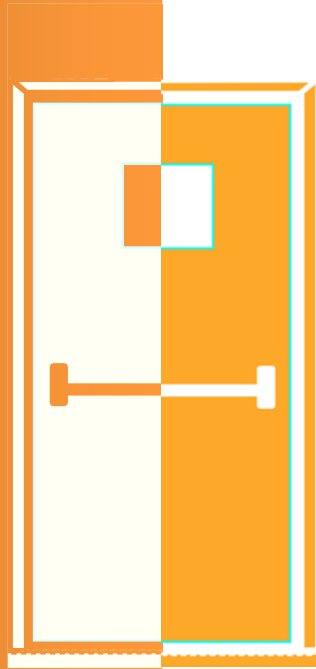

## FIRE RATED DOOR

---

Honeycomb, Rockwool & Glazed



# FIRE DOORS

## CONTENT INDEX



	Page
1a INTRODUCTION .....	3
UL APPROVED FIRE RATED DOORS .....	5
Honeycomb Fire Rated Door .....	6
Rockwool Fire Rated Door .....	7
Optional Features .....	8
Vision Panel .....	8
Louver .....	9
Transom .....	10
2 INTERTEK APPROVED FIRE RATED DOORS .....	12
Honeycomb Fire Rated Door .....	13
Rockwool Fire Rated Door .....	14
Optional Features .....	15
Vision Panel .....	15
Louver .....	16
3 BM TRADA APPROVED FIRE RATED DOORS .....	18
Honeycomb Fire Rated Door .....	19
Rockwool Fire Rated Door .....	20
Optional Features .....	21
Vision Panel .....	21
Louver .....	22
4 FULL GLAZED FIRE RATED DOORS .....	24
BM Trada and Intertek Approved Fire Rated Door .....	25
5 LOUVER .....	26
Introduction .....	27
Size and Drawings .....	28
6 FIRE RATED ACCESS PANEL DOORS .....	29
Intertek Approved .....	30
BM Trada Approved .....	31
7 IRONMONGERY .....	32
Ironmongery for Fire Rated Doors .....	33-36
8 DOOR COMPONENTS .....	37
9 STANDARD DOOR FRAME DETAILS .....	38
10 DOOR INFILLS .....	39
11 TECHNICAL DRAWING .....	40
12 CERTIFICATES .....	41-44

# FIRE DOORS

## INTRODUCTION

### FIRE DOORS

Fire Doors are doors with fire-resistance rating and play an important role in fire protection and loss prevention.

They are used as part of a passive fire protection system to reduce the spread of fire or smoke between compartments. Fire Doors enable safe escape from a building or structure during events like fire, earthquake, etc. Since Fire Doors have a distinct purpose, they have additional special characteristics than those of ordinary doors.

### EASE OF ACCESS

Since fire doors are meant to be the safest exit points in cases of fire, they are usually painted with bright red color to be visible during emergency, and are often attached with push bars for ease of opening during fire panicking.

### VISIBILITY

In interior application to separate compartment zones, Fire Doors are most of the times required to be fitted with vision panels so that flames or smoke may be seen and collisions avoided.

### FIRE RATING

The most important attribute of Fire Doors is its fire rating. Fire rating is the door's capability to withstand fire and remain intact for the duration. Fire rating is measured in minutes (sometimes hours) the fire door was able to maintain integrity while subjected to fire.

### AIR TIGHTNESS

Fire Doors serve as the access between the safe egress and a burning compartment, it is therefore important that fire doors do not permit smoke to the safe side. Fire doors are fitted with smoke seals to address this factor.

### STEEL FIRE DOOR

Steel products are rugged, long lasting and offer great endurance through time. They resist environmental stress like heat and humidity that adversely impact other door and frame products. Steel products are easy to maintain and ensure virtually trouble free operation for many years.

Steel door and frame products are also an ideal solution to any degree of security.

To meet the varied needs of the construction industry, **BRISTOL FIRE ENGINEERING (BFE)** manufactures a wide range of steel doors and frames for interior and exterior use. BFE doors are the most reliable door manufactured, by using only the highest quality materials and manufacturing techniques. BFE doors are produced in many sizes, gauges and design to meet the needs or architects, owners requirements and contractors.

A door with a fire-resistance rating (sometimes referred to as a fire protection rating for closures) used as part of a passive fire protection system to reduce the spread of fire and smoke between separate compartments of a structure and to enable safe egress from a building or structure.

### ADVANTAGES

1. Fire Rated doors help facilitate the safe and quick evacuation of occupants.
2. Fire Rated doors help minimize damage to the property.
3. Fire Resistant doors prevent the loss of lives.
4. Fire Rated doors Restrict and delay the spread of fire



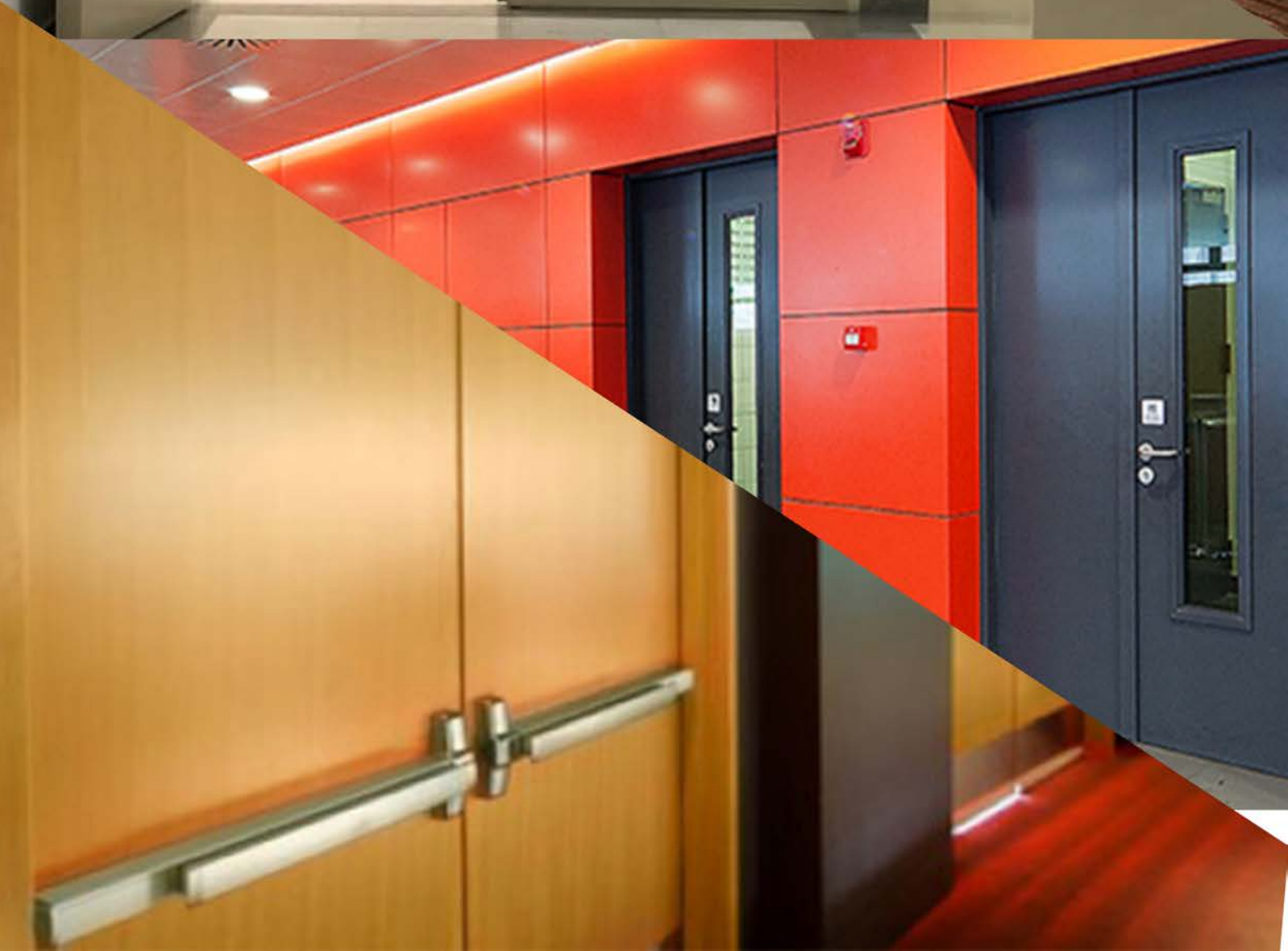



# UL APPROVED FIRE RATED DOOR

---

TECHNICAL DATASHEETS



**BRISTOL**

# FIRE DOORS

## HONEYCOMB FIRE RATED DOOR



### HONEYCOMB CORE DOORS

Honeycomb door has a paper kraft core. The core is permanently bonded to the door skins strengthening the structural integrity of the door, enhancing long term performance and durability, while significantly reducing the weight.

### STEEL FIRE DOOR

#### Specifications:

- Type : Single and Double
- Door thickness : 44mm
- Finish : Factory polyester powder coating
- Astragal : On active leaf of double doors
- Top/Bottom Channels : Inverted U-Channel

#### FIRE RATINGS

ANSI/UL10C- Up to 120 minutes

ANSI/UL10B- Up to 120 minutes



#### SIZES

Approval	Standard	Infill	Door	Range	Frame Height (mm)	x	Frame width (mm)	Fire Rating (Min)
UL	10B & 10C	Honey comb	Single	Max	2500	x	1300	120
UL	10B & 10C	Honey comb	Double	Max	2195	x	2190	120

# FIRE DOORS

## ROCKWOOL FIRE RATED DOOR



### ROCKWOOL CORE DOORS

The Rockwool Core BRISTOL uses for its fire doors has service temperature of 780°C when tested in accordance to DIN 52271. Additionally, the core is water repellent, non-hygroscopic, and non-capillary.

### STEEL FIRE DOOR

#### Specifications:

- Type : Double
- Door thickness : 44mm
- Finish : Factory polyester powder coating
- Astragal : On active leaf of double doors
- Top/Bottom Channels : Inverted U-Channel



#### FIRE RATINGS

ANSI/UL10B & ANSI/UL10C - Single up to 120 minutes; Double up to 90 minutes

#### SIZES

Approval	Standard	Infill	Door	Range	Frame Height (mm)	x	Frame width (mm)	Fire Rating (Min)
UL	10B & 10C	Rockwool	Single	Max	2500	x	1300	120
UL	10B & 10C	Rockwool	Double	Max	2995	x	2790	90

# FIRE DOORS

## OPTIONAL FEATURES



### VISION PANELS OPTION

The glass light frame is intended to be used in classified hollow metal type; Rock-wool core and honeycomb type doors.

Fire Rated Steel Glass Light Frame should be installed above 1100 mm from the floor level

Glass light frame should be Galvanized sheet as per the approvals Glass Light Frame is welded from one side on the door and for the other side as follows



#### ANSI/UL10C (OPTIONS)

- a. Mechanical Interlocking joints
- b. Screw fixing (M5 X 40 mm minimum)

#### ADVANTAGES

1. Vision Panels are option to view, to allow people entering and exiting to see the other side of the door.
2. Reducing the potential to hit by swinging the door, Vision panels are a way of bringing borrowed light into inner spaces and creating a sense of openness. Vision panels are advanced to use to avoid space in sidelights, transoms or other glazing options.

### VISION PANEL SIZE

Approval	Standard	Glazing Height (mm)	x	Glazing Width (mm)	Fire Rating (min)
UL	10B & 10C	250	X	250	120



\*\*Applicable for Single and Double door for Honeycomb doors

\*\* Applicable for Double door for Rockwool core doors

\*\* Available in other design types

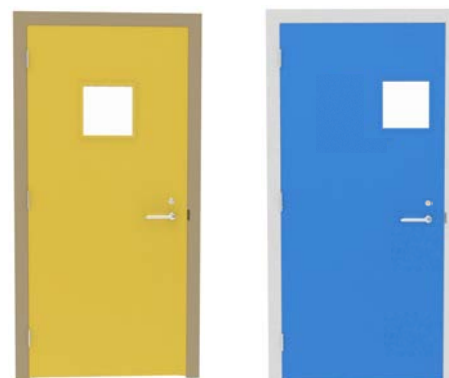

Vision Square



# FIRE DOORS

## OPTIONAL FEATURES



### LOUVER

To be maximum 24" x 24" with fusible link only at the lower portion of the doors.

#### APPLICATION

Allowed to be used in fire rated honeycomb infill and Rockwool infill .

Fire Rated Steel Louver should be installed below 1000 mm height from the floor level in the bottom half of the door leaf, minimum distance of the louver cut out from the door edges / as per our approval

Louver cut out – 1.5 mm thick galvanized steel C- Channel should be used around the steel louver for the reinforcement.

Louver Frame and Beading – 1.2 mm Galvanized Steel

Frame is welded to the door leaf and beading is fixed using M4 x 12 mm self- tapping screws, 3 nos. on each sides.

Louver blade – 1.2 mm thick galvanized steel blades are used.



#### ADVANTAGES

Louver provides free passages of air and sufficient light. It provides protection against excessive daylight and glare inside buildings without in any way affecting ventilation to create maximum air flow in and out.

#### LOUVER SIZE

Approval	Standard	Louver Height (mm)	x	Louver Width (mm)	Fire Rating (min)
UL	10B & 10C	610 (24")	X	610 (24")	90

\*\* Applicable for Single and Double door for Honeycomb doors

\*\* Applicable for Double door for Rockwool core doors



# STEEL DOORS

## OPTIONAL FEATURES



### TRANSOM FRAME

#### SIZES

Type	Door	Frame Height (mm)	x	Frame Width (mm)
Over Size	Single	3000	x	1500
Over Size	Double	3000	x	3000



*\*\*Special size available as per customer requirement.*

*\*\* Applicable for Single and Double door for Honeycomb Infill & Rockwool Infill doors.*





# INTERTEK APPROVED FIRE RATED DOOR

---

TECHNICAL DATASHEETS



Intertek

**BRISTOL**

# FIRE DOORS

## HONEYCOMB FIRE RATED DOOR



## HONEYCOMB CORE DOORS

Honeycomb door has a paper kraft core. The core is permanently bonded to the door skins strengthening the structural integrity of the door, enhancing long term performance and durability, while significantly reducing the weight.

## STEEL FIRE DOOR

### Specifications:

- Type : Single and Double
- Door thickness : 44mm
- Finish : Factory polyester powder coating
- Astragal : On active leaf of double doors
- Top/Bottom Channels : Inverted U-Channel



### FIRE RATINGS

According to BS 476 standards Integrity Up to 240 minutes

### SIZES

Approval	Standard	Infill	Door	Range	Frame Height (mm)	x	Frame Width (mm)	Fire Rating (min)
Intertek	BS 476	Honey Comb	Double	Max	2176	x	2327	30/60/ 90/120
				Max	2724	x	1859	
Intertek	BS 476	Honey Comb	Double	Max	2182	x	2148	180
				Max	2514	x	1865	
Intertek	BS 476	Honey Comb	Double	Max	2095	x	1790	240
Intertek	BS 476	Honey Comb	Single	Max	2176	x	1287	30/60/ 90/120
				Max	2724	x	1028	
Intertek	BS 476	Honey Comb	Single	Max	2182	x	1188	180
				Max	2514	x	1031	
Intertek	BS 476	Honey Comb	Single	Max	2095	x	990	240

# FIRE DOORS

## ROCKWOOL FIRE RATED DOOR



## ROCKWOOL CORE DOORS

The Rockwool Core BRISTOL uses for its fire doors has service temperature of 780°C when tested in accordance to DIN 52271. Additionally, the core is water repellent, non-hygroscopic, and non-capillary.

## STEEL FIRE DOOR

### Specifications:

- Type : Single and Double
- Door thickness : 44mm
- Finish : Factory polyester powder coating
- Astragal : On active leaf of double doors
- Top/Bottom Channels : Inverted U-Channel



### FIRE RATINGS

According to BS 476 standards Integrity Up to 160 minutes for Double and 240 minutes for Single.

## SIZES

Approval	Standard	Infill	Door	Range	Frame Height (mm)	x	Frame Width (mm)	Fire Rating (min)
Intertek	BS 476	Rockwool	Double	Max	2186	x	2058	30/60/ 90/120
				Max	2409	x	1868	
Intertek	BS 476	Rockwool	Double	Max	2095	x	1790	160
Intertek	BS 476	Rockwool	Single	Max	2176	x	1287	30/60/ 90/120
				Max	2724	x	1028	
Intertek	BS 476	Rockwool	Single	Max	2182	x	1188	180
				Max	2514	x	1031	
Intertek	BS 476	Rockwool	Single	Max	2095	x	990	240

# FIRE DOORS

## OPTIONAL FEATURES



### VISION PANELS OPTION

The glass light frame is intended to be used in classified hollow metal type; Rockwool core and honeycomb type doors.

Fire Rated Steel Glass Light Frame should be installed above 1100 mm from the floor level

Glass light frame should be Galvanized sheet as per the approvals (BS Standard)

Glass Light Frame is welded from one side on the door and for the other side as follows

#### BS 476 PART 22

- a. Screw fixing (M5 X 40 mm minimum)



### ADVANTAGES

1. Vision Panels are option to view, to allow people entering and exiting to see the other side of the door.
2. Reducing the potential to hit by swinging the door, Vision panels are a way of bringing borrowed light into inner spaces and creating a sense of openness. Vision panels are advanced to use to avoid space in sidelights, transoms or other glazing options.



### VISION PANEL SIZE FOR HONEYCOMB DOORS

Approval	Standard	Range	Glazing Height (mm)	x	Glazing Width (mm)	Fire Rating (min)
Intertek	BS 476	Max	690	x	402	120
Intertek	BS 476	Max	600	x	350	240

\*\* Available in other design types

### VISION PANEL SIZE FOR ROCKWOOL DOORS

Approval	Standard	Range	Glazing Height (mm)	x	Glazing Width (mm)	Fire Rating (min)
Intertek	BS 476	Max	575	x	402	120
Intertek	BS 476	Max	500	x	350	240



Vision Square

\*\* Available in other design types

# FIRE DOORS

## OPTIONAL FEATURES



### LOUVER

To be maximum 24" x 24" with fusible link only at the lower portion of the doors.

### APPLICATION

Allowed to be used in fire rated honeycomb infill and rockwool infill.

Fire Rated Steel Louver should be installed below 1000 mm height from the floor level in the bottom half of the door leaf, minimum distance of the louver cut out from the door edges / as per our approval

Louver cut out – 1.5 mm thick galvanized steel C- Channel should be used around the steel louver for the reinforcement.

Louver Frame and Beading – 1.2 mm Galvanized Steel

Frame is welded to the door leaf and beading is fixed using M4 x 12 mm self- tapping screws, 3 nos. on each sides.

Louver blade – 1.2 mm thick galvanized steel blades are used.

### LOUVER SIZE

Approval	Standard	Louver Height (mm)	x	Louver Width (mm)	Fire Rating (min)
Intertek	BS 476	610 (24")	x	610 (24")	240

\*\* Applicable for Single and Double door for Honeycomb infill & rockwool infill doors.



### ADVANTAGES

Louver provides free passages of air and sufficient light. It provides protection against excessive daylight and glare inside buildings without in any way affecting ventilation to create maximum air flow in and out.









# BM TRADA APPROVED FIRE RATED DOOR

---

TECHNICAL DATASHEETS



**BRISTOL**

# FIRE DOORS

## HONEYCOMB FIRE RATED DOOR



### HONEYCOMB CORE DOORS

Honeycomb door has a paper kraft core. The core is permanently bonded to the door skins strengthening the structural integrity of the door, enhancing long term performance and durability, while significantly reducing the weight.

### STEEL FIRE DOOR

#### Specifications:

Type	: Single and Double
Door thickness	: 44mm
Finish	: Factory polyester powder coating
Astragal	: On active leaf of double doors
Top/Bottom Channels	: Inverted U-Channel



#### FIRE RATINGS

According to BS 476 standards Integrity Up to 120 minutes

#### SIZES

Approval	Standard	Infill	Door	Range	Frame Height (mm)	x	Frame Width (mm)	Fire Rating (min)
BM TRADA	BS 476	Honey Comb	Single	From	2293	x	1198	120
				To	2519	x	1097	
BM TRADA	BS 476	Honey Comb	Double	From	2293	x	2294	120
				To	2519	x	2092	

# FIRE DOORS

## ROCKWOOL FIRE RATED DOOR



### ROCKWOOL CORE DOORS

The Rockwool Core BRISTOL uses for its fire doors has service temperature of 780°C when tested in accordance to DIN. Additionally, the core is water repellent, non-hygroscopic, and non-capillary.

### STEEL FIRE DOOR

#### Specifications:

- Type : Single and Double
- Door thickness : 44mm
- Finish : Factory polyester powder coating
- Astragal : On active leaf of double doors
- Top/Bottom Channels : Inverted U-Channel



#### FIRE RATINGS

According to BS 476 standards Integrity 90 minutes Single and 120 minutes Double.

#### SIZES

Approval	Standard	Infill	Door	Range	Frame Height (mm)	x	Frame Width (mm)	Fire Rating (min)
BM TRADA	BS 476	Rockwool	Single	From	2501	x	1198	90
				To	2749	x	1097	
BM TRADA	BS 476	Rockwool	Double	From	2501	x	2294	120
				To	2749	x	2092	

# FIRE DOORS

## OPTIONAL FEATURES



### VISION PANELS OPTION

The glass light frame is intended to be used in classified hollow metal type; Rockwool core and honeycomb type doors.

Fire Rated Steel Glass Light Frame should be installed above 1100 mm from the floor level

Glass light frame should be Galvanized sheet as per the approvals (BS Standard)

Glass Light Frame is welded from one side on the door and for the other side as follows

#### BS 476 PART 22

- a. Screw fixing (M5 X 40 mm minimum)



### ADVANTAGES

1. Vision Panels are option to view, to allow people entering and exiting to see the other side of the door.
2. Reducing the potential to hit by swinging the door, Vision panels are a way of bringing borrowed light into inner spaces and creating a sense of openness. Vision panels are advanced to use to avoid space in sidelights, transoms or other glazing options.



### VISION PANEL SIZE FOR HONEYCOMB DOORS

Approval	Standard	Range	Glazing Height (mm)	x	Glazing Width (mm)	Fire Rating (min)
BM TRADA	BS 476	From	626	x	517	120
		To	690	x	469	

\*\* Available in other design types

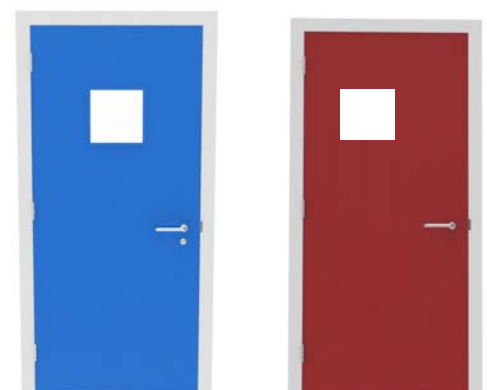

### VISION PANEL SIZE FOR ROCKWOOL DOORS

Approval	Standard	Range	Glazing Height (mm)	x	Glazing Width (mm)	Fire Rating (min)
BM TRADA	BS 476	From	660	x	400	120
		To	480	x	550	

\*\* Available in other design types

Vision Square

# FIRE DOORS

## OPTIONAL FEATURES



### LOUVER

To be maximum 24" x 24" with fusible link only at the lower portion of the doors.

### APPLICATION

Allowed to be used in fire rated honeycomb infill and rockwool infill.

Fire Rated Steel Louver should be installed below 1000 mm height from the floor level in the bottom half of the door leaf, minimum distance of the louver cut out from the door edges / as per our approval

Louver cut out – 1.5 mm thick galvanized steel C- Channel should be used around the steel louver for the reinforcement.

Louver Frame and Beading – 1.2 mm Galvanized Steel

Frame is welded to the door leaf and beading is fixed using M4 x 12 mm self- tapping screws, 3 nos. on each sides.

Louver blade – 1.2 mm thick galvanized steel blades are used.



### ADVANTAGES

Louver provides free passages of air and sufficient light. It provides protection against excessive daylight and glare inside buildings without in any way affecting ventilation to create maximum air flow in and out.

### LOUVER SIZE

Louver Height (mm)	x	Louver width (mm)
610	x	610

\*\* Applicable for Single and Double door (Rockwool & Honeycomb)





# FIRE RATED FULL GLAZED DOOR

TECHNICAL DATASHEETS



Intertek



**BRISTOL**



# FIRE DOORS

## FULL GLAZED FIRE DOOR

### FULLY GLAZED STEEL DOOR

These Decorative Front Doors are durable in construction and are largely used in varied applications like lift lobby, offices, main entrance doors, corridor doors, airport and banks. It's attractive modern look and adds a touch of class to the building décor without sacrificing the fire rating requirements.

#### INTERTEK APPROVED

##### Specifications:

Type	: Double
Door thickness	: 44mm
Finish	: Factory polyester powder coated
Astragal	: On active leaf of double doors
Glass	: Fire Rated Glass

##### FIRE RATINGS

According to BS 476 part 22 standards Integrity up to 60minutes.

##### SIZES

Approval	Standard	Infill	Door	Range	Frame Height (mm)	x	Frame Width (mm)	Fire Rating (min)
Intertek	BS 476	Honeycomb	Double	From	2311	x	2518	60
				To	2547	x	2285	



#### BM TRADA APPROVED

##### Specifications:

Type	: Double
Door thickness	: 44mm
Finish	: Factory polyester powder coated
Astragal	: On active leaf of double doors
Glass	: Fire Rated Glass

##### FIRE RATINGS

According to BS 476 part 22 standards Integrity up to 60minutes.

##### SIZES

Approval	Standard	Infill	Door	Range	Frame Height (mm)	x	Frame Width (mm)	Fire Rating (min)
BM TRADA	BS 476	Honeycomb	Double	Max	2215	x	2190	60



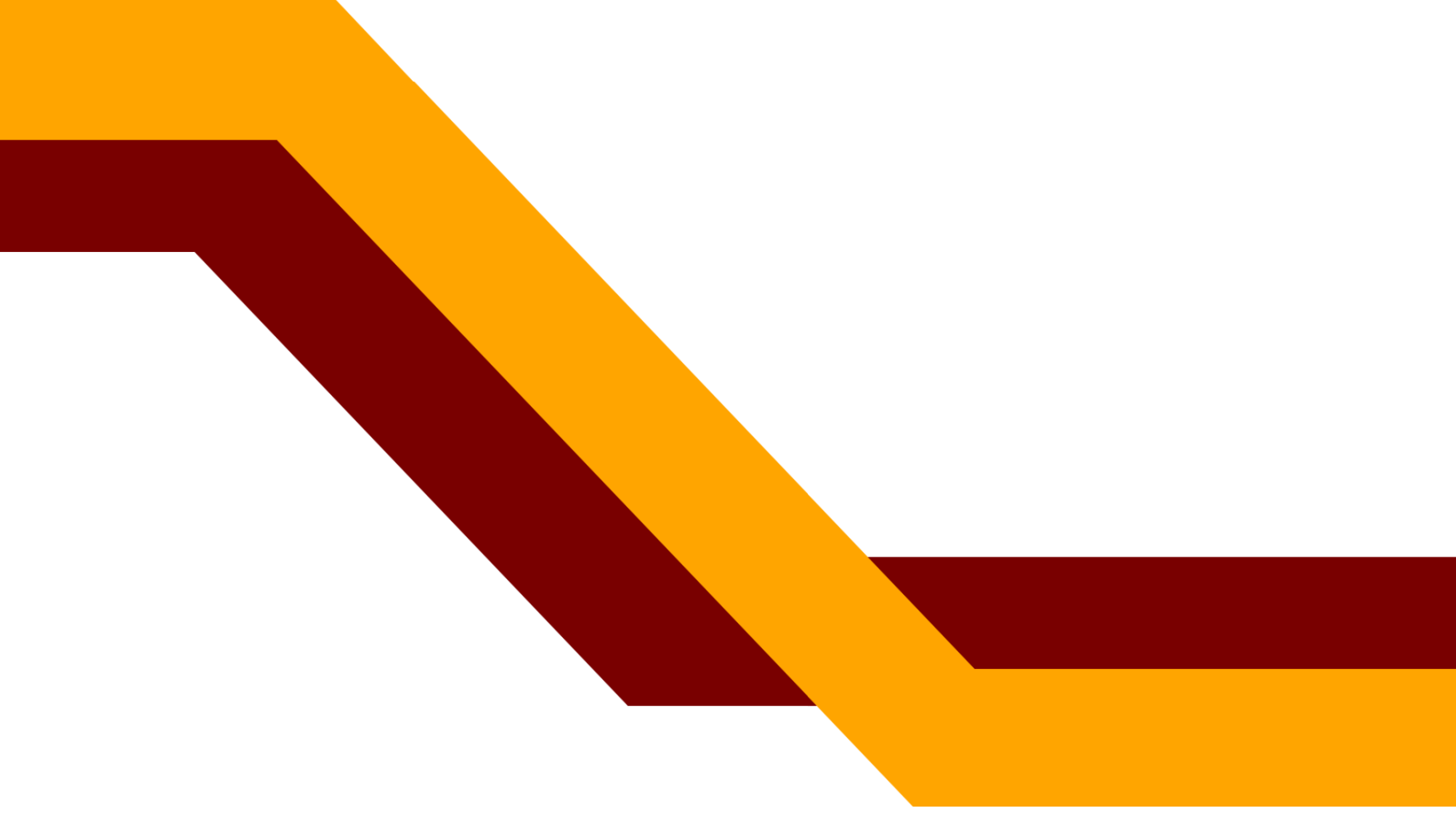

# LOUVER

TECHNICAL DATASHEETS



Intertek

**BRISTOL**

# FIRE DOORS

## LOUVER



## LOUVER

### STANDARD PRODUCT FEATURES

**MATERIAL:** 18 GA. (1.2mm) Cold Rolled Steel Frame and Louver Blades, 16 GA. (1.5mm) inner support members.

**FINISH:** Grey Primer, Beige or Bronze Baked Enamel.

**INSTALLATION:** Self attaching using #8 x 1" (25mm) phillips head screws that fasten the auxiliary frame to the louver core, thru the cut out in the door. The corridor side of the frame is free of fasteners for added security.

**DOOR THICKNESS:** 1 3/4" (44mm) Door is Standard. Also available up to 2 1/2" (64mm) Door (to maintain fire rating).

**CLOSING ASSEMBLY:** Stainless steel operating springs assure proper action with the closing mechanism.

**AESTHETICS:** Tight mitered corners and countersunk mounting holes make for a clean appearance.

**USES:** In fire rated door applications.

**FREE AIR FLOW:** 40% Free Area.

### OPTIONAL PRODUCT FEATURES

**MATERIAL:** #304 or #316 Stainless Steel, #4 Finish (Satin), or Galvanized (Coil or Zinc Plated).

**FINISH:** Custom-Baked Enamel Colors (as per sample chip supplied by customer).

**FASTENERS:** Special security screw fasteners.

**SCREENS:** 18-14 mesh insert screens, framed or attached. (Galvanized, Aluminum, Charcoal Aluminum, or Stainless Steel).

### ADVANTAGES

Louver provides free passages of air and sufficient light. It provides protection against excessive daylight and glare inside buildings without in any way affecting ventilation to create maximum air flow in and out.

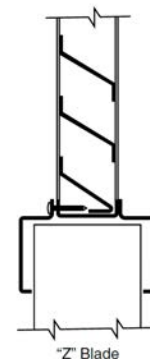

Standard Louver design

# FIRE DOORS

## LOUVER



### LOUVER SIZE

Approval	Standard	Range	Louver Height (mm)	x	Louver width (mm)	Fire Rating (min)
Intertek	BS 476	Max	610	x	610	240

### DETAILED DRAWING

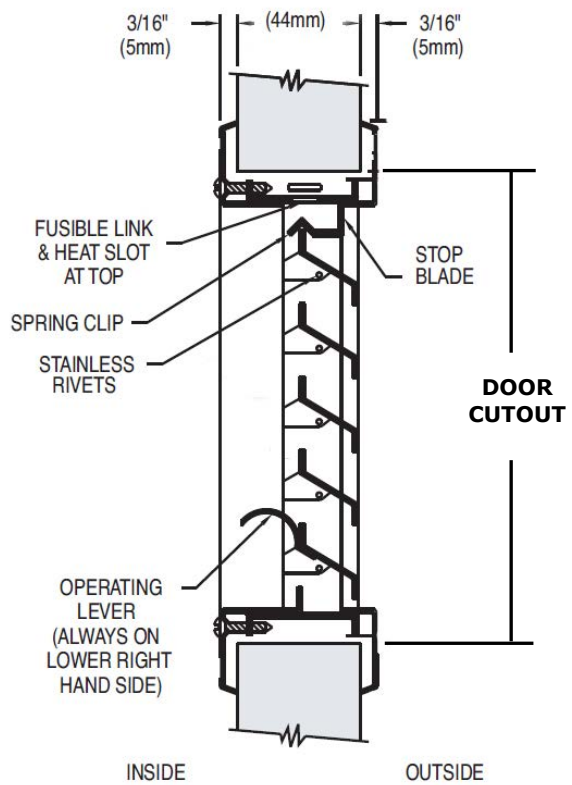
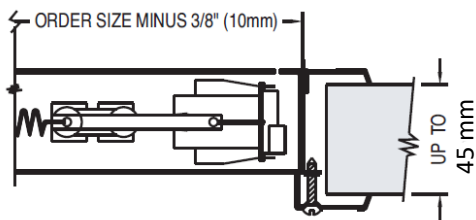

# FIRE RATED ACCESS PANEL DOOR

TECHNICAL DATASHEETS



Intertek



**BRISTOL**

# FIRE DOORS

## ACCESS PANEL DOOR



### ACCESS PANEL DOOR

The Access Panel frame is intended to be used in rockwool and honey-comb type doors.

The Access Panel frame should use with 0.8 to 1.5 mm Galvanized sheet as per the approvals.

The Access Panel is welded from as per the Approval for the fire door.

#### ADVANTAGES

1. Access control panels are the best option for businesses and industrial buildings.
2. The use of Access panels is now a good option compared to the standard or engineering doors
3. The access doors can be used in areas that require high security

#### Specifications:

Type	: Single and Double
Door thickness	: 44mm
Finish	: Factory polyester powder coating
Astragal	: On active leaf of double doors
Top/Bottom Channels	: Inverted U-Channel

#### FIRE RATINGS

According to BS 476 part 22 standards Integrity up to 240 minutes.



#### SIZES

Approval	Standard	Infill	Door	Range	Frame Height (mm)	x	Frame Width (mm)	Fire Rating (Min)
Intertek	BS 476	Honey comb	Double	Max	2176	X	2327	30/60/90/120
				Max	2724	X	1859	
Intertek	BS 476	Honey comb	Double	Max	2182	X	2148	180
				Max	2514	X	1865	
Intertek	BS 476	Honey comb	Double	Max	2095	X	1790	240
Intertek	BS 476	Honey comb	Single	Max	2176	X	1287	30/60/90/120
				Max	2724	X	1028	
Intertek	BS 476	Honey comb	Single	Max	2182	X	1188	180
				Max	2514	X	1031	
Intertek	BS 476	Honey comb	Single	Max	2095	X	990	240
Intertek	BS 476	Rockwool	Double	Max	2186	X	2058	30/60/90/120
				Max	2409	X	1868	
Intertek	BS 476	Rockwool	Double	Max	2095	X	1790	160
Intertek	BS476	Rockwool	Single	Max	2176	X	1287	30/60/90/120
				Max	2724	X	1028	
Intertek	BS 476	Rockwool	Single	Max	2182	X	1188	180
				Max	2514	X	1031	
Intertek	BS 476	Rockwool	Single	Max	2095	x	990	240

# FIRE DOORS

## ACCESS PANEL DOOR



### Specifications:

- Type : Single and Double
- Door thickness : 44mm
- Finish : Factory polyester powder coating
- Astragal : On active leaf of double doors
- Top/Bottom Channels : Inverted U-Channel



### FIRE RATINGS

According to BS 476 part 22 standards Integrity up to 120 minutes.

### SIZES

Approval	Standard	Infill	Door	Range	Frame Height (mm)	x	Frame Width (mm)	Fire Rating (Min)
BM TRADA	BS 476	Honey comb	Single	From	2293	x	1198	120
				To	2519	x	1097	
BM TRADA	BS 476	Honey comb	Double	From	2293	x	2294	120
				To	2519	x	2092	
BM TRADA	BS 476	Rockwool	Single	From	2501	x	1198	90
				To	2749	x	1097	
BM TRADA	BS 476	Rockwool	Double	From	2501	x	2294	120
				To	2749	x	2092	

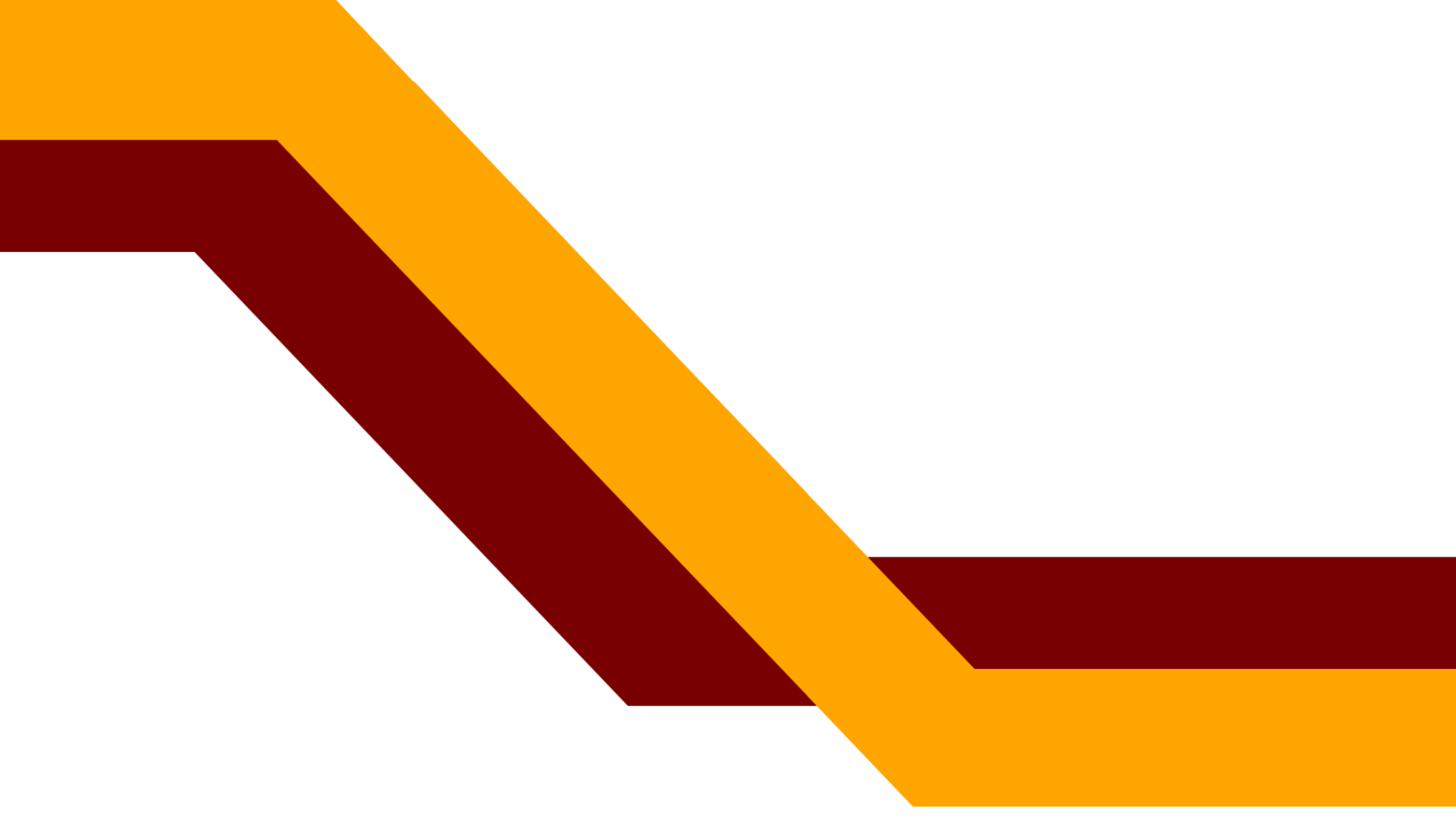

# **IRONMONGERY**

---



# FIRE DOORS

## IRONMONGERY FOR FIRE RATED DOORS



### OVERHEAD DOOR CLOSER



- ◆ UL Listed
- ◆ Suitable for Left and Right Hand Application
- ◆ Suitable for Fire Door use in all Applications
- ◆ Delayed Action Version Available
- ◆ Simple Power Size Adjustment with Supplied Key
- ◆ Two separate valves adjustable closing and latching speed
- ◆ Applicable to fire rated door : UL

### EXTERNAL LEVER TRIM



- ◆ Ideal for public/office doors here a more ergonomic operation is a necessary requirement.
- ◆ Grade 304 Stainless Steel, Zinc Alloy
- ◆ Suitable for all domestic, commercial and industrial use.
- ◆ Applicable to fire rated door : UL , BM TRADA, and Intertek

### DOOR STOPPER

- ◆ Small shielded half moon shaped door stop with a substantial rubber buffer to protect doors.
- ◆ Floor mounted type
- ◆ Stainless Steel
- ◆ Suitable for domestic and commercial use.
- ◆ Applicable to fire rated door : UL , BM TRADA, and Intertek



### PUSH BAR PANIC LATCH



- ◆ UL 10C Fire Rated for use on and metal doors
- ◆ Security Anti-Thrust latch
- ◆ Touch bar length of device : 500mm
- ◆ Available in different finishes.
- ◆ Applicable to fire rated door : UL

# FIRE DOORS

## IRONMONGERY FOR FIRE RATED DOORS



### HINGE



- ◆ UL Listed 3 Hours fire rating
- ◆ All hinges with 5 knuckle
- ◆ Dimensions and Tolerances confirm to ANSI-A 156.7
- ◆ Ball bearing hinges have always been very popular for their smooth operation, durability, long lasting design and ability to carry heavier loads.
- ◆ Applicable to fire rated door : UL

### HINGE



- ◆ The most popular type of door hinge on the market today.
- ◆ They have a CE mark and are Certifire tested.
- ◆ Suitable for industrial, commercial and domestic use.
- ◆ Ball bearing hinges have always been very popular for their smooth operation, durability, long lasting design and ability to carry heavier loads.
- ◆ Applicable to fire rated door : BM TRADA and Intertek

### LEVER HANDLE



- ◆ EN1634 Fire rated Certification
- ◆ A substantial 19mm round bar return to door safety lever.
- ◆ Ideal for public/office doors here a more ergonomic operation is a necessary requirement.
- ◆ Grade 304 Stainless Steel, Zinc Alloy
- ◆ Suitable for all domestic, commercial and industrial use.
- ◆ Applicable to fire rated door : BM TRADA and Intertek

### OVERHEAD DOOR CLOSER



Overhead Door Closer Variable Power Size 2-5. Delayed Action. Certified to BS EN 1125 and BS 8300 to meet the needs of disabled people. CE marked and Certifire tested. Suitable for Left and Right Hand Application

- ◆ Suitable for Fire Door use in all Applications
- ◆ Delayed Action Version Available
- ◆ Simple Power Size Adjustment with Supplied Key
- ◆ Applicable to fire rated door : BM TRADA and Intertek

# FIRE DOORS

## IRONMONGERY FOR FIRE RATED DOORS



### PUSH BAR PANIC LATCH



The single push bar panic door kit would usually be found on a fire exit door in commercial and industrial premises. This system has a dogging function for easy use with a 'hold-open' action which enables the exit door to be used as a normal service door during the day. Bolt retracts, permitting free access.

- ◆ Certified to BS EN 1125. CE mark and Certifire tested.
- ◆ Aluminum finish.
- ◆ Applicable to fire rated door : BM TRADA, and Intertek

### SASH LOCK



The Latch bolt has the Easi-T reverse function to save undoing the case so it can be reversed in seconds.

- ◆ BS EN 12209 Rated. Used as a matter of course by the national house builders.
- ◆ It has been CE and Certifire tested.
- ◆ Suitable for use in all domestic, industrial and commercial environments.
- ◆ Applicable to fire rated door : BM TRADA, and Intertek

### D-TYPE PULL HANDLE



- ◆ Range in grade 304 Stainless Steel, so ideal for internal and external homes and offices.
- ◆ Available in different sizes.
- ◆ These pull handles are fixed with 2no M8 threaded bolts through the door giving the strongest fixing possible.
- ◆ Fire door rated.
- ◆ Suitable for domestic and commercial use.
- ◆ Applicable to fire rated door : Intertek and BM Trada Full glazed door

### ESKUTCHEON



- ◆ provide a high degree of security, having met the standards identified by Secured by Design the UK policed flagship initiative.
- ◆ Features include; anti drill, anti pick, anti bump, fire door rated.
- ◆ Certified to British/European standards (BS EN 1303). Keyed alike or master keyed options available.
- ◆ Suitable for domestic, commercial and industrial use.
- ◆ Applicable to fire rated door : UL, BM TRADA, and Intertek

# FIRE DOORS

## IRONMONGERY FOR FIRE RATED DOORS



### SLIM DOOR CLOSER



Concealed Slim Door Closer

- ◆ Carries the CE mark and is Certifire accredited.
- ◆ Certified to BS EN 1154 and BS 8300 to meet the needs of disabled people
- ◆ Suitable for all domestic, commercial and industrial use.
- ◆ Suitable for Left and Right Hand Application
- ◆ Suitable for Fire Door use in all Applications
- ◆ Applicable to fire rated door : Intertek and BM Trada Full glazed door

# FIRE DOORS

## DOOR COMPONENTS



### HONEYCOMB CORE DOOR

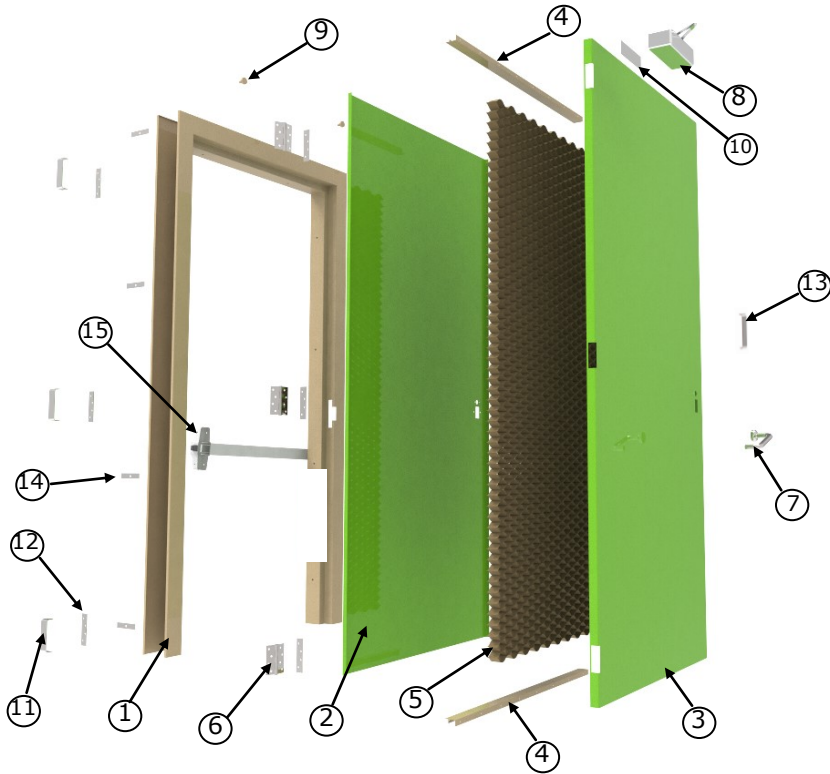

1. Door Frame
2. Door Cover
3. Door Door base
4. Inverted U channels
5. Honeycomb
6. Ball bearing Hinge
7. External Lever Trim
8. Door Closer
9. Door Silencer
10. Door Closer Reinforcement
11. Hinge Cover
12. Hinge Plate
13. Lock Cover
14. Frame jamb support
15. Push bar panic latch

### ROCKWOOL CORE DOOR

1. Door Frame
2. Door Cover
3. Door Base
4. Inverted U channels
5. Rockwool
6. Ball bearing Hinge
7. External Lever Trim
8. Door Closer
9. Door Silencer
10. Door Closer Reinforcement
11. Hinge Cover
12. Hinge Plate
13. Lock Cover
14. Frame jamb support
15. Push bar panic latch

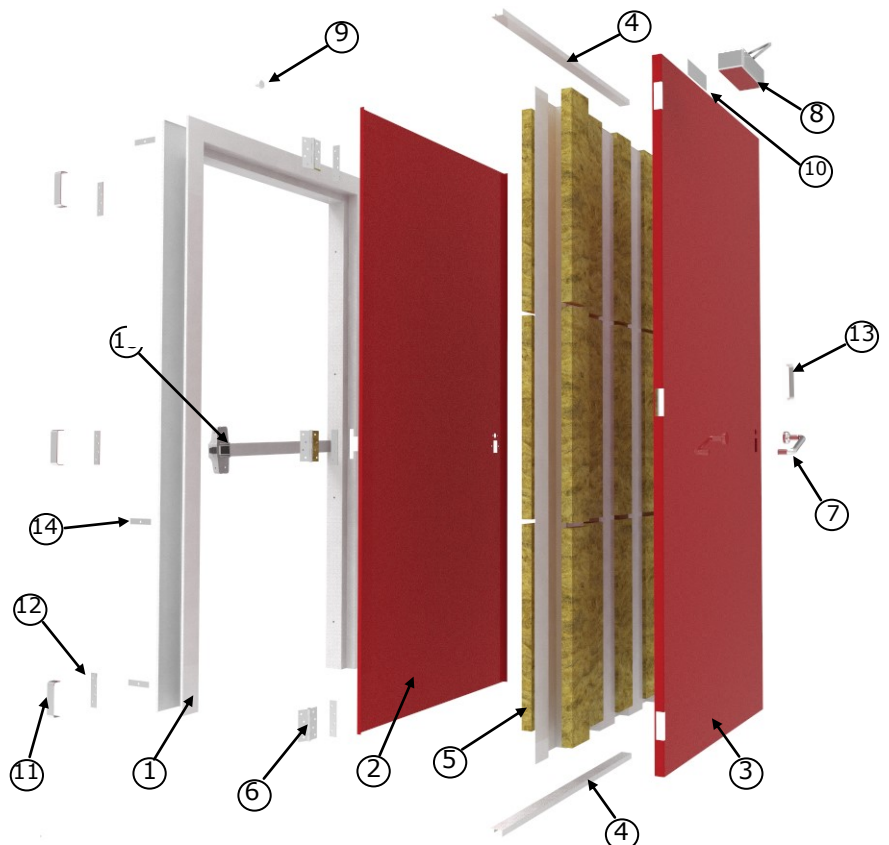

# FIRE DOORS

## Standard Door Frame Details



### DOOR FRAME

**Material:** Galvanized Steel

- ◆ Single and Double leaf door frames
- ◆ Available in different standard frame profiles

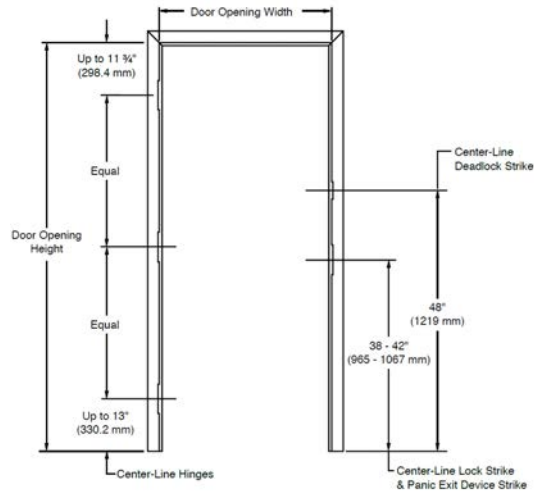

### DOOR FRAME PROFILES

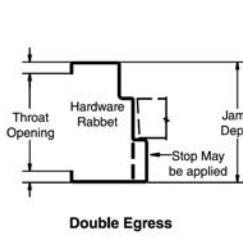
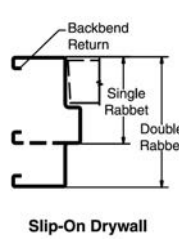
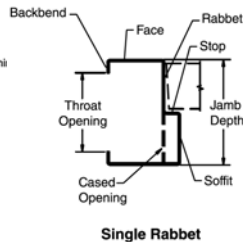
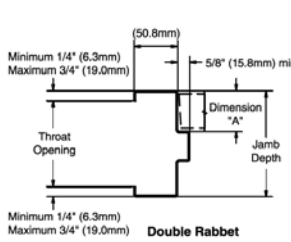

Door Thk.	Dim. "A"
1-3/8" (34.9mm)	1-9/16" (39.6mm)
1-3/4" (44.4mm)	1-15/16" (49.2mm)

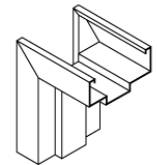
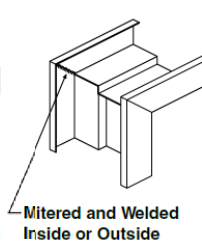
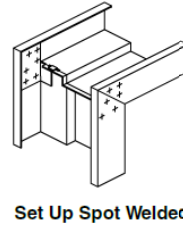
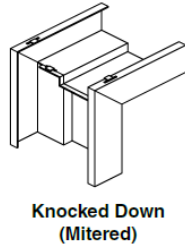
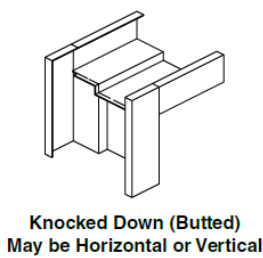

Slip-on Drywall (frame is installed after the wall has been erected). Corner may be screwed together, snap locked, or a slip fit design.

### STANDARD ANCHOR TYPES

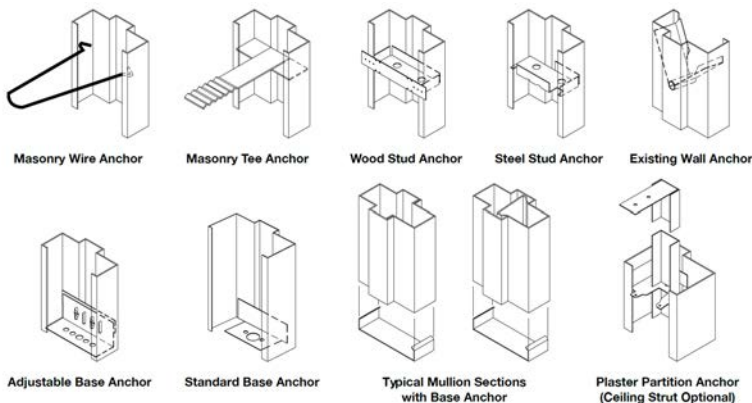

### DOOR HANDLING CHART

DOOR HANDLING CHART				*INDICATES KEY SIDE
SINGLE DOORS		PAIRS OF DOORS		
INSIDE RH RIGHT HAND	INSIDE LH LEFT HAND	INSIDE ACTIVE RIGHT HAND	INSIDE ACTIVE LEFT HAND	
INSIDE RHR RIGHT HAND REVERSE	INSIDE LHR LEFT HAND REVERSE	INSIDE ACTIVE RIGHT HAND REVERSE	INSIDE ACTIVE LEFT HAND REVERSE	

# FIRE DOORS

## Door Infill



### HONEYCOMB INFILL

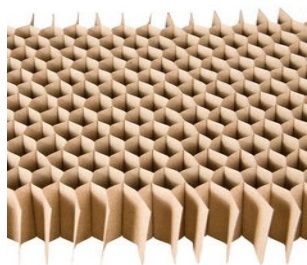

#### Paper Honey Comb Core

As door infill, the rigid honeycomb structure is integrated with the door to form hundreds of small I- beams with the door, with a uniform thickness and flat surface that makes it easy to add lites, louvers or other features. It reinforces the full width and height of the door. Honeycomb Core Doors may be used in exterior or interior applications.

**Paper material** : high strength corrugated/craft paper in 140g/m<sup>2</sup>

**Hone Comb Core cell Size** : 12 mm side size;

**Width** : 1250mm before expanding

**Thickness** : 41 mm

#### Honeycomb advantages are:

- 1- High strength to weight ratio.
- 2- Uniform crushing strength.
- 3- High shear strength
- 4- Excellent impact resistance.

### ROCKWOOL INFILL



Rockwool, as the name implies is made by melting diabase rock mixed with coke and limestone, then converted to fibers. The raw material diabase (basalt rock) is a pure volcanic material which is millions of years old. Rockwool is classified as an inorganic material and has an excellent resistance to high temperatures and possesses superior acoustic properties.

#### Other important properties are as follow:

- Water Absorption tested according to BS2972: Section 12 and ASTM C-209
- Thermal Conductivity in accordance with BS 874, equivalent ASTM C-177/C 518
- Sound Absorption in accordance with BS 3638 & ISO 354, equivalent ASTM C 423
- Non-combustible in accordance with BS 476: Part 4 1970 and ASTM E-136, Class A to ASTM E-84

# FIRE DOORS

## DRAWINGS

### SINGLE DOOR

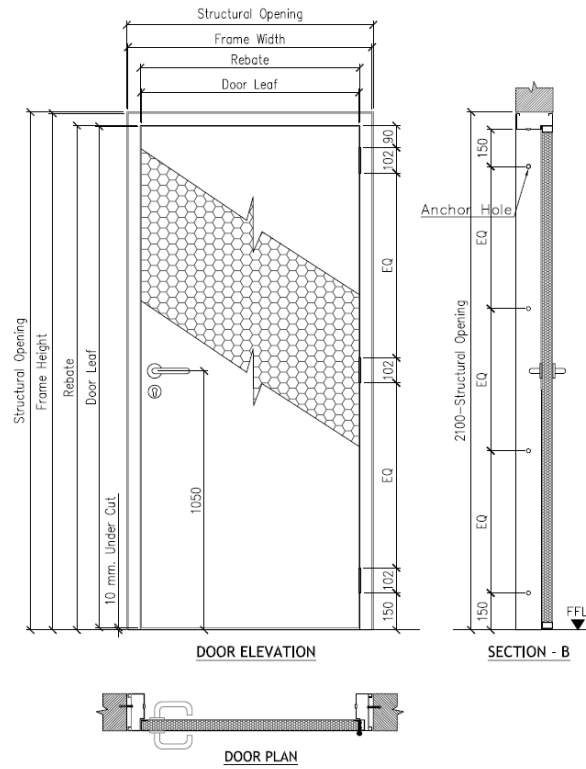

### DOUBLE DOOR

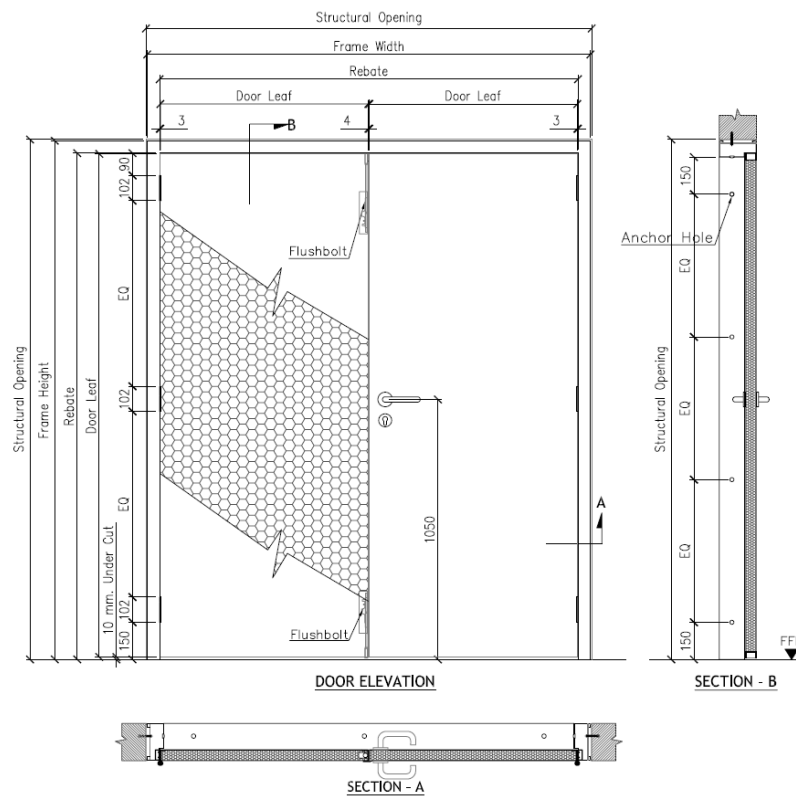



# FIRE DOORS

## CERTIFICATES



### CERTIFICATE OF COMPLIANCE

**Certificate Number** 20130513-R27746  
**Report Reference** R27746-20130513  
**Issue Date** 2013-MAY-13

**Issued to:** BRISTOL FIRE ENGINEERING L L C  
AL QUOZ INDUSTRIAL AREA 3  
PO BOX 74582  
DUBAI UNITED ARAB EMIRATES

**This is to certify that representative samples of** FIRE DOOR AND WINDOW FRAMES  
The single-unit type, pressed-steel frames for walls at least 2 inches (50.8 mm) thick.

Have been investigated by UL in accordance with the Standard(s) indicated on this Certificate.

**Standard(s) for Safety:** UL Subject 63, Outline of Investigation for Fire Door Frames.

**Additional Information:** See the UL Online Certifications Directory at [www.ul.com/database](http://www.ul.com/database) for additional information

Only those products bearing the UL Listing Mark should be considered as being covered by UL's Listing and Follow-Up Service.

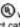
The UL Listing Mark generally includes the following elements: the symbol UL in a circle,  with the word "LISTED"; a control number (may be alphanumeric) assigned by UL; and the product category name (product identifier) as indicated in the appropriate UL Directory.

Look for the UL Listing Mark on the product.

*William P. Casey*  
William P. Casey, Director, North American Certification Program  
UL LLC



Page 1 of 1

### CERTIFICATE OF COMPLIANCE

**Certificate Number** 20160216-R27745  
**Report Reference** R27745-20130625  
**Issue Date** 2016-FEBRUARY-16

**Issued to:** BRISTOL FIRE ENGINEERING L L C  
AL QUOZ INDUSTRIAL AREA 3  
PO BOX 74582  
DUBAI UNITED ARAB EMIRATES

**This is to certify that representative samples of** SWINGING-TYPE FIRE DOORS, POSITIVE-PRESSURE TESTED

Single leaf swinging type and double leaf swinging type fire door, Model FDD120  
Additional Information: Glazing 100 sq. in.

Have been investigated by UL in accordance with the Standard(s) indicated on this Certificate.

**Standard(s) for Safety:** UL 10C, Positive Pressure Fire Tests of Door Assemblies

**Additional Information:** See the UL Online Certifications Directory at [www.ul.com/database](http://www.ul.com/database) for additional information

Only those products bearing the UL Certification Mark should be considered as being covered by UL's Certification and Follow-Up Service.

Look for the UL Certification Mark on the product.

*Barry Kelly*  
Barry Kelly, Director, North American Certification Program  
UL LLC



Page 1 of 1

### CERTIFICATE OF COMPLIANCE

**Certificate Number** R27745  
**Report Reference** R27745-20210521  
**Date** 2021-May-31

**Issued to:** BRISTOL FIRE ENGINEERING L L C  
AL QUOZ INDUSTRIAL AREA 3  
PO BOX 74582  
DUBAI AE

**This is to certify that representative samples of** SWINGING-TYPE FIRE DOORS, POSITIVE-PRESSURE TESTED; SWINGING-TYPE FIRE DOORS  
See Addendum Page for Product Designation(s).

Have been investigated by UL in accordance with the Standard(s) indicated on this Certificate.

**Standard(s) for Safety:** ANSII/UL 10C Standard for Positive Pressure of Fire Tests of Door Assemblies

ANSII/UL 10B Standard for Fire Tests of Door Assemblies

**Additional Information:** See the UL Online Certifications Directory at <https://iq.ulprospect.com> for additional information

This Certificate of Compliance does not provide authorization to apply the UL Mark. Only the UL Follow-Up Services Procedure provides authorization to apply the UL Mark.

Only those products bearing the UL Mark should be considered as being UL Certified and covered under UL's Follow-Up Services.

Look for the UL Certification Mark on the product.

*Barry Kelly*  
Barry Kelly, Director, North American Certification Program  
UL LLC



Any information and documentation including UL Mark evidence are provided on behalf of UL LLC (UL) or any authorized licensee of UL. For questions, please contact a local UL Customer Service Representative at [ULCustomerService@ul.com](mailto:ULCustomerService@ul.com)

### CERTIFICATE OF COMPLIANCE

**Certificate Number** R27745  
**Report Reference** R27745-20210520  
**Date** 2021-May-31

**Issued to:** BRISTOL FIRE ENGINEERING L L C  
AL QUOZ INDUSTRIAL AREA 3  
PO BOX 74582  
DUBAI AE

**This is to certify that representative samples of** SWINGING-TYPE FIRE DOORS, POSITIVE-PRESSURE TESTED; SWINGING-TYPE FIRE DOORS  
See Addendum Page for Product Designation(s).

Have been investigated by UL in accordance with the Standard(s) indicated on this Certificate.

**Standard(s) for Safety:** ANSII/UL 10C Standard for Positive Pressure of Fire Tests of Door Assemblies

ANSII/UL 10B Standard for Fire Tests of Door Assemblies

**Additional Information:** See the UL Online Certifications Directory at <https://iq.ulprospect.com> for additional information

This Certificate of Compliance does not provide authorization to apply the UL Mark. Only the UL Follow-Up Services Procedure provides authorization to apply the UL Mark.

Only those products bearing the UL Mark should be considered as being UL Certified and covered under UL's Follow-Up Services.

Look for the UL Certification Mark on the product.

*Barry Kelly*  
Barry Kelly, Director, North American Certification Program  
UL LLC



Any information and documentation including UL Mark evidence are provided on behalf of UL LLC (UL) or any authorized licensee of UL. For questions, please contact a local UL Customer Service Representative at [ULCustomerService@ul.com](mailto:ULCustomerService@ul.com)

# FIRE DOORS

## CERTIFICATES



### CERTIFICATE OF COMPLIANCE

Certificate Number 20160621-R27745  
Report Reference R27745-20160620  
Issue Date 2016-JUNE-21

Issued to: BRISTOL FIRE ENGINEERING L L C  
AL QUOZ INDUSTRIAL AREA 3  
PO BOX 74582  
DUBAI UNITED ARAB EMIRATES

This is to certify that representative samples of SWINGING-TYPE FIRE DOORS, POSITIVE-PRESSURE TESTED  
A pair of swinging-type fire door assembly of the hollow metal type with mineral wool core, rated up to and including 1-1/2 hr.

Have been investigated by UL in accordance with the Standard(s) indicated on this Certificate.

Standard(s) for Safety: ANSI/UL 10C, Positive Pressure of Fire Tests of Door Assemblies  
ANSI/UL 10B, Fire Tests of Door Assemblies

Additional Information: See the UL Online Certifications Directory at [www.ul.com/database](http://www.ul.com/database) for additional information

Only those products bearing the UL Certification Mark should be considered as being covered by UL's Certification and Follow-Up Service.

Look for the UL Certification Mark on the product.

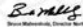
  
Bruce Mahoney, Director, North American Certification Program  
UL LLC

Any information and documentation involving UL Mark services are provided on behalf of UL LLC (UL) or any authorized licensee of UL. For questions, please contact a local UL Customer Service Representative at [ULCustomerService@ul.com](mailto:ULCustomerService@ul.com)



Page 1 of 1

### CERTIFICATE OF COMPLIANCE

Certificate Number 20160627-R38819  
Report Reference R38819-20160627  
Issue Date 2016-JUNE-27

Issued to: BRISTOL FIRE ENGINEERING L L C  
AL QUOZ INDUSTRIAL AREA 3  
PO BOX 74582  
DUBAI UNITED ARAB EMIRATES

This is to certify that representative samples of FIRE DOOR GLASS LIGHT FRAMES  
Model BF-LF-ML-001 - The glass light frame is intended to be used in Classified hollow-metal type, steel stiffened and honeycomb type doors, rated up to and including 2 hr

Have been investigated by UL in accordance with the Standard(s) indicated on this Certificate.

Standard(s) for Safety: ANSI/UL 10B, Fire Tests of Door Assemblies  
ANSI/UL 10C, Positive Pressure of Fire Tests of Door Assemblies

Additional Information: See the UL Online Certifications Directory at [www.ul.com/database](http://www.ul.com/database) for additional information

Only those products bearing the UL Certification Mark should be considered as being covered by UL's Certification and Follow-Up Service.

Look for the UL Certification Mark on the product.

  
Bruce Mahoney, Director, North American Certification Program  
UL LLC

Any information and documentation involving UL Mark services are provided on behalf of UL LLC (UL) or any authorized licensee of UL. For questions, please contact a local UL Customer Service Representative at [ULCustomerService@ul.com](mailto:ULCustomerService@ul.com)



Page 1 of 1

### CERTIFICATE OF COMPLIANCE

Certificate Number 20160627-R38819  
Report Reference R38819-20160628  
Issue Date 2016-JUNE-27

Issued to: BRISTOL FIRE ENGINEERING L L C  
AL QUOZ INDUSTRIAL AREA 3  
PO BOX 74582  
DUBAI UNITED ARAB EMIRATES

This is to certify that representative samples of FIRE DOOR GLASS LIGHT FRAMES  
Model BF-LF-SW-001 - The glass light frame is intended to be used in Classified hollow-metal type, steel stiffened and honeycomb type doors, rated up to and including 2 hr

Have been investigated by UL in accordance with the Standard(s) indicated on this Certificate.

Standard(s) for Safety: ANSI/UL 10B, Fire Tests of Door Assemblies  
ANSI/UL 10C, Positive Pressure of Fire Tests of Door Assemblies

Additional Information: See the UL Online Certifications Directory at [www.ul.com/database](http://www.ul.com/database) for additional information

Only those products bearing the UL Certification Mark should be considered as being covered by UL's Certification and Follow-Up Service.

Look for the UL Certification Mark on the product.

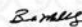
  
Bruce Mahoney, Director, North American Certification Program  
UL LLC

Any information and documentation involving UL Mark services are provided on behalf of UL LLC (UL) or any authorized licensee of UL. For questions, please contact a local UL Customer Service Representative at [ULCustomerService@ul.com](mailto:ULCustomerService@ul.com)



Page 1 of 1

# FIRE DOORS

## CERTIFICATES



Report prepared for: Melchor De Guzman (BRISTOL Fire Engineering L.L.C.) on 8/27/2018 6:56:35 AM

### Certificate of Compliance - Bristol - Honeycomb infill door assembly - E 240 - BS 476 Part 22

**intertek**  
Total Quality Assured

**Certificate of Compliance**

You have been awarded:  
**Intertek Warnock Hersey Mark for fire resistant doors and door sets**  
BS 476 Part 22 (1987), BS 476 Part 20 (1987)  
Certificate number: WH18 - 31725201

**Organization:**  
BRISTOL Fire Engineering L.L.C.  
P.O. Box 74582  
AI Quoz Industrial Area 3  
Dubai, United Arab Emirates

**Product:**  
Bristol: Honeycomb Infill - Single and Double Leaf Door and Frame Assembly - BS 476 Part 22  
For details related to maximum dimensions and allowable configurations, see Appendix A (page 2 of 3 and 3 of 3 of this certificate)  
For full details of the certified product please refer to Spec ID 44289

**Certification body:** Intertek Testing Services NA, Inc.  
Initial registration: May 30, 2018  
Date of expiry: December 31, 2021  
Issue status: 1

Charles Meyers  
Certification Manager  
Name: [Signature] Date: 30 May 2018

Requester address:  
Intertek Testing Services NA, Inc. 545 E. Algonquin Rd., Arlington Heights, IL 60005 USA

www.intertek.com

BRISTOL Fire Engineering L.L.C. | 44289 | Rev: Aug 7 2018 1:32PM | Uncontrolled Copy

Page 6 of 8

**intertek**  
Total Quality Assured

### Certificate of Compliance

**intertek**  
Total Quality Assured

You have been awarded:  
**WH Service Mark 2014 for Fire Door Components**  
Standards: BS 476 Part 22 (1987), BS 476 Part 20 (1987)  
Certificate number: WH18-31725202

**Organization:** BRISTOL Fire Engineering L.L.C.  
P.O. Box 74582  
AI Quoz Industrial Area 3  
Dubai  
United Arab Emirates

**Product:** Bristol: Fusible Link Steel Louvers - BS 476 Part 22  
Spec ID: 44307  
Fire Rating: 4 Hour Fire Rated  
Listing information: See following page(s)

**Certification body:** Intertek Testing Services NA, Inc.  
Initial registration: May 31, 2018  
Date of expiry: December 31, 2021  
Issue status: 1

Authorized By:  
Jean-Philippe Kayl, Director of Certification  
Intertek Testing Services NA, Inc.  
545 E. Algonquin Road, Ste 11, Arlington Heights, IL 60005 USA  
Phone: 847-439-5867 Fax: 847-439-7320

www.intertek.com

www.intertek.com

BRISTOL Fire Engineering L.L.C. | 44307 | Rev: Jan 19 2021 4:09PM | Uncontrolled Copy

Page 1 of 2

Report prepared for: Melchor De Guzman (BRISTOL Fire Engineering L.L.C.) on 8/27/2018 6:53:30 AM **Spec DIRECT** powered by **intertek**

### Certificate of Compliance - Bristol - Rockwool infill door assembly - E 120 - BS 476 Part 22

**intertek**  
Total Quality Assured

**Certificate of Compliance**

You have been awarded:  
**Intertek Warnock Hersey Mark for fire resistant doors and door sets**  
Certificate number: WH18 - 31725203

**Organization:**  
BRISTOL Fire Engineering L.L.C.  
P.O. Box 74582  
AI Quoz Industrial Area 3  
Dubai, United Arab Emirates

**Product:**  
Bristol: Rockwool Infill - Double Leaf Door and Frame Assembly - BS 476 Part 22  
For details related to maximum dimensions and allowable configurations, see Appendix A (page 2 of 3 and 3 of 3 of this certificate)  
For full details of the certified product please refer to Spec ID 44309

**Certification body:** Intertek Testing Services NA, Inc.  
Initial registration: June 19, 2018  
Date of expiry: December 31, 2018  
Issue status: 1

Charles Meyers  
Certification Manager  
Name: [Signature] Date: 19 June 2018

Requester address:  
Intertek Testing Services NA, Inc. 545 E. Algonquin Rd., Arlington Heights, IL 60005 USA

www.intertek.com

BRISTOL Fire Engineering L.L.C. | 44359 | Rev: Jul 31 2018 2:28PM | Uncontrolled Copy

Page 6 of 78

Report prepared for: Melchor De Guzman (BRISTOL Fire Engineering L.L.C.) on 8/27/2018 6:54:32 AM **Spec DIRECT** powered by **intertek**

### Certificate of Compliance - Bristol Fully Glazed Double Leaf Door & Frame Assembly - E 60 - BS 476 Part 22

**intertek**  
Total Quality Assured

**Certificate of Compliance**

You have been awarded:  
**Intertek Warnock Hersey Mark for fire resistant doors and door sets**  
BS 476 Part 22 (1987), BS 476 Part 20 (1987)  
Certificate number: WH18 - 31725204

**Organization:**  
BRISTOL Fire Engineering L.L.C.  
P.O. Box 74582  
AI Quoz Industrial Area 3  
Dubai, United Arab Emirates

**Product:**  
Bristol: Fully Glazed Double Leaf Door & Frame Assembly - BS 476 Part 22  
For details related to maximum dimensions and allowable configurations, see Appendix A (page 2 of 2 of this certificate)  
For full details of the certified product please refer to Spec ID 44703

**Certification body:** Intertek Testing Services NA, Inc.  
Initial registration: July 02, 2018  
Date of expiry: December 31, 2018  
Issue status: 1

Charles Meyers  
Certification Manager  
Name: [Signature] Date: 02 July 2018

Requester address:  
Intertek Testing Services NA, Inc. 545 E. Algonquin Rd., Arlington Heights, IL 60005 USA

www.intertek.com

BRISTOL Fire Engineering L.L.C. | 44703 | Rev: Jul 31 2018 10:09AM | Uncontrolled Copy

Page 6 of 61

# FIRE DOORS

## CERTIFICATES

912

Certificate Number  
658

Date of Initial Certification  
10 January 2013

Date of last issue  
18 March 2019

Date of Expiry  
9 January 2022



### CERTIFICATE OF REGISTRATION

This is to certify that

**Bristol Fire Engineering**  
P.O. Box 74582  
Al Qouz Industrial Area 3  
Dubai  
United Arab Emirates

Meets the requirements of the BM TRADA Q-Mark International Fire Door Manufacture scheme to **STD 096 - Issue 3 - 01/12/2015** which only operates in Bahrain, Egypt, Iraq, Jordan, Kuwait, Lebanon, Libya, Oman, Qatar, Saudi Arabia and The United Arab Emirates for the products on the attached schedule

**Karen Prendergast**  
Divisional Director - Certification  
BM TRADA

Warrington Testing and Certification Limited is a BM TRADA, Children's Home, Stocking Lane, High Wycombe, Buckinghamshire, HP14 4SD, UK. Registered Office: Warrington Testing and Certification Limited, 10 Lower Governor Place, London, SE14 6PA, UK. Reg No. 1057946.

This certificate remains the property of Warrington Testing and Certification Limited. This certificate and all copies or reproductions of the certificate shall be returned to Warrington Testing and Certification Limited or destroyed if requested. Further certification regarding the issue of this certificate and verification of the certificate is available through the TRADA or all the above address or at [info@warrington.co.uk](mailto:info@warrington.co.uk)



#### Registration Schedule

Establishment	Address
P.O. Box 74582 Al Qouz Industrial Area 3 Dubai United Arab Emirates	

#### Scope

Assessment/ Test Report	Doorset Description	Rating	Test Type
Chil/A 13186	Steel Doorset – Rockwool core – 240	240min	BS 476 Part 22
Chil/A 12306	Steel Doorset – Honey Comb core – 120	120min	BS 476 Part 22
TBWIC/M33	Bristol Fire – Steel Honey Comb Door – 120	120min	BS 476 Part 22
TBWIC/NB54	Bristol Fire – Steel Rockwool Single Door – 90	90min	BS 476 Part 22
TBWIC/NB54	Bristol Fire – Steel Rockwool Double Door – 120	120min	BS 476 Part 22
TBWIC/NH19	Bristol Fire – Steel Full Glazed Door – 60	60min	BS 476 Part 22
TBWIC/M33	Bristol Fire – Steel Honey Comb Access Panel – 120	120min	BS 476 Part 22
TBWIC/NB54	Bristol Fire – Steel Rockwool Access Panel – 90	90min	BS 476 Part 22

This certification is awarded to the company named above and is not transferable

# Over 100 Distributors Worldwide

## UAE Offices

### Abu Dhabi

#### Concorde Trading Company

Tel: +971 2 6668770 Fax: +971 2 6667863

#### Concorde Trading Showroom

Tel: +971 2 4433317 Fax: +971 2 4434746

#### Concorde Technical Company

Tel: +971 2 5575551 Fax: +971 2 5575550

#### Bristol Vehicles Manufacturing Division

Tel: +971 2 5575551 Fax: +971 2 5575550

### Al Ain

#### Concorde Trading Company

Tel: +971 3 7642267 Fax: +971 3 7642268

### Sharjah

#### Corodex Agencies

Tel: +971 6 5430800 Fax: +971 6 5430801

### Dubai

#### Corodex Trading Company

Tel: +971 4 3472900 Fax: +971 4 3472796

#### Corodex Agencies (Fire Protection & Automation)

Tel: +971 4 3472530 Fax: +971 4 3472501

#### Bristol Fire Engineering

Tel: +971 4 3472426 Fax: +971 4 3472363

#### Corodex Agencies (Safety & Rescue)

Tel: +971 4 2668966 Fax: +971 4 2624617

## International Offices

### Oman

#### Integrated Engineering Solutions (IES)

Tel: +968 24700349 Fax: +968 24700631

### KSA

#### Concorde Advance Technical Solutions

Tel: +966 12 6984993 Fax: +966 12 6984991

**BRISTOL**  
FIRE ENGINEERING

P.o.Box 74582 Dubai, UAE

Tel: +971 4 3472426 Fax: +971 4 3472363

Email: [sales@bristol-fire.com](mailto:sales@bristol-fire.com), [www.bristol-fire.com](http://www.bristol-fire.com)

Member of



Since 1974

Concorde - Corodex Group



Intertek



NFPA



FM  
APPROVED



UL  
LISTED

